

MONOBLOCK WITH MULTIPLE SECTIONS ISO 03

MRK-3-*G

80 l/min 30 MPa (300 bar)

1 DESCRIPTION

Ports A and B (3/8" BSP) on the back P and T lines with ports (1/2" BSP) on the two rear sides Parallel connections P and T Monoblocks with multiple sections from 2 to 8, for hydraulic 4 ways operated valves ISO 03 with parallel internal connections P and T. Ports A and B are positioned on the back side of the block relative to the valve assembly face.

2 ORDERING CODE

(1)	(2)	(3)	(4)
MRK	-	3	G

3 TECHNICAL DATA

Material:	Cast Iron GG 25
Coating:	Manganese phosphating
Pressure allowed in the ports:	P, A, B and T = 300 bar
Incoming flow, maximum recommended: (*)	From 40 to 80 l/min, decreasing with the rise of the number of sections. If both pairs of ports P and T are used, maximum recommended Q values can be increased.
Connecting ports:	Standard cylindrical BSP thread with maximum rugosity of a surface Ra 1,6 for the fitting of connections.
A and B ports P:	3/8" BSP one pair per section
P and T:	1/2" BSP one pair on each rear side of a monoblock; it allows to double supply if needed (P) or double outlet (T); close the unused ports

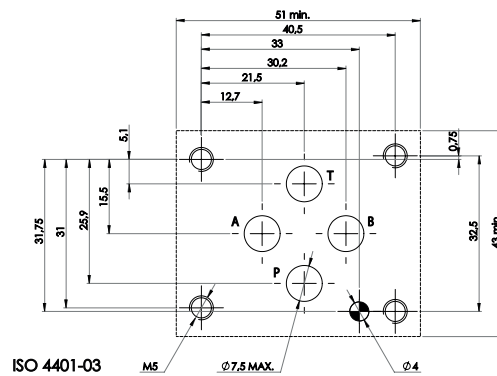

Type	Number of sections 03	Q max recommended (*) l/min
MRK-3-2 G	2	80 - 80
MRK-3-3 G	3	60 - 80
MRK-3-4 G	4	60 - 80
MRK-3-5 G	5	50 - 80
MRK-3-6 G	6	50 - 80
MRK-3-7 G	7	40 - 80
MRK-3-8 G	8	40 - 80

4 INSTALLATION DIMENSIONS (mm)

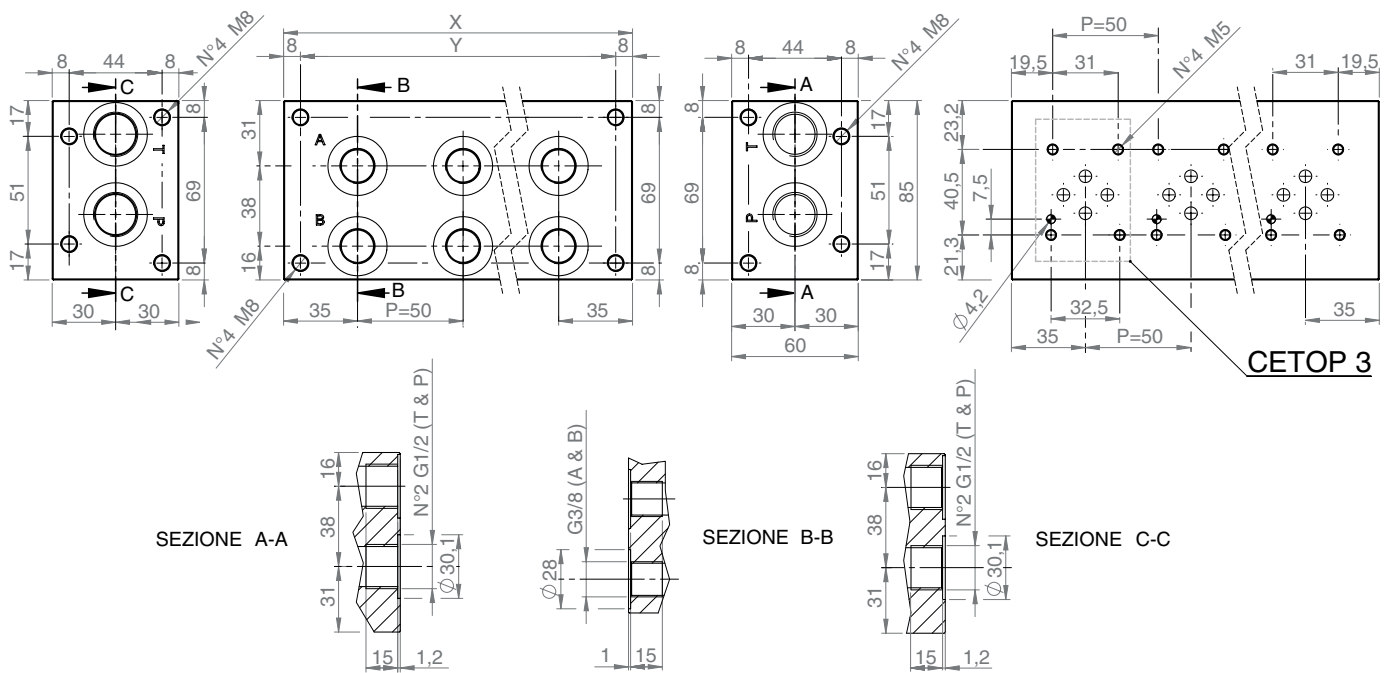

4 mounting holes threaded M8 on the rear side

5 HYDRAULIC FLUID

Seals and materials used on standard valves MRK-3-*G are fully compatible with hydraulic fluids of mineral oil base, upgraded with antifoaming and antioxidantizing agents. The hydraulic fluid must be kept clean and filtered to ISO 4406 class 19/17/14, or better, and used in a recommended viscosity range from 10 cSt to 60 cSt

Type	X (mm)	Z (mm)	mass (kg)
MRK-3-2G	120	104	3,90
MRK-3-3G	170	154	5,45
MRK-3-4G	220	204	7,00
MRK-3-5G	270	254	8,55
MRK-3-6G	320	304	10,10
MRK-3-7G	370	354	11,65
MRK-3-8G	420	404	13,20

6 MOUNTING SURFACE OF THE VALVE:

Planarity of the surface: 0,01/100

Rugosity: Ra 0,8

Every section has a mounting surface according to ISO 4401-03.